

# Industrial Bluetooth® 5.0 Beacon with accelerometer sensor

Tatwah Technology Co., Ltd.



## Specifications

Descriptions	<p>The Industrial Bluetooth® IT005 tag corresponds to the latest generation of Bluetooth® beacons developed by Tatwah. The tag is compatible with Bluetooth® 5.0 standard and it is designed to full fill all requirements for asset tracking, logistics, item management or predictive maintenance use cases.</p> <p>Due to its optimized and ultra-low power consumption, the beacon guaranties un-surpassed battery lifetimes with, and in addition, the possibility to replaceable its AA batteries. Its high precision accelerometer sensor permits to detect any movements, vibrations, shocks or a specific fall. The accelerometer parameters are configurable in order to adjust them to the final needs of the application.</p> <p>All beacon configuration parameters can be updated over-the-air through a specific profile service.</p>
Applications	Asset Tracking, Logistics, Predictive Maintenance and Inventory Control

## Electronic

Technology	<p>Eddystone URL, iBeacon protocols supported</p> <p>Accelerometer sensor</p> <p>Two LEDs: Green and Red color</p> <p>Duress button capability</p>
Operating Frequency	Bluetooth® 2.45 GHz and Optional 13.56 MHz
LDAP client	“Call By name” with direct access to the company directory through a dedicated key
Standards	Bluetooth® Low Energy V 5.0



Module	TWHBC01	
Battery	Reference	Two replaceable AA batteries
	Lifetime	Up to 8 years depending on the Bluetooth® beacon parameters

## Datasheet

INDUSTRIAL Bluetooth® 5.0 BEACON with ACCELEROMETER SENSOR

Reading Range	Up to 100 meters for Bluetooth® Low Energy LOS of 200 meters		
Sensors	Accelerometer	User-selectable full scales of ±2g/±4g/±8g/±16g and is capable of measuring accelerations with output data rates from 1.6 Hz to 1600 Hz	
Press Switch Button	Duress button available for events and alerts		

#### Physical

Dimensions	Length	70.00 mm	Width	49.00 mm
	Thickness			
Weight	125.00 g			
Color	Front : white	Back : black		
Material	ABS / PC			

#### Chemical and Mechanical

Thermal Properties	Operating Temp.	-20°C to +54°C	-4°F to +129°F
	Storage Temp.	-20°C to +54°C	-4°F to +129°F
Environmental and Chemical Properties	IP68 (1m, 24h)		
	Saltwater, salt mist, acetic acid water, carbonated sodium water, sugared water, ethylene glycol, humidity 95% (50°C, 24h)		
Certificates	Bluetooth®, CE, FCC, ISED, RoHS & Reach conform. Conflict free sourcing <a href="http://www.conflictfreesourcing.org">www.conflictfreesourcing.org</a>		

#### Options

Firmware	ALEFW-IT005-01 (01 for the revision of the FW)		
Pre-configuration mode	ALEFW-IT005-01" + TAG TURNED OFF (customer activate the tag at reception)		
Lasering	Front	QR code and switch button logo (refer to layout)	
	Back	Model, FCC ID, IC ID, CE and recycle logo (refer to layout)	
NFC	None		

#### Others

Beacon attachment	Black PE foam adhesive A1 (not glued to the beacon)		
QR Code	Content	mac@, model (e.g. as defined in SIG Bluetooth specification), unique ID (model+ Last 5 digits of MAC), UUID, Major & Minor (default iBeacon Configuration), unique Tatwah SA ID order number (BEAxxxx-xxx_revision)	
	Example	AB:12:CD:34:EF:56,IT005,IT0054EF56,D70F4BBC-981F-4252-BC01-334EC1DF653D,5678,321, BEA0541-001	

#### Layout

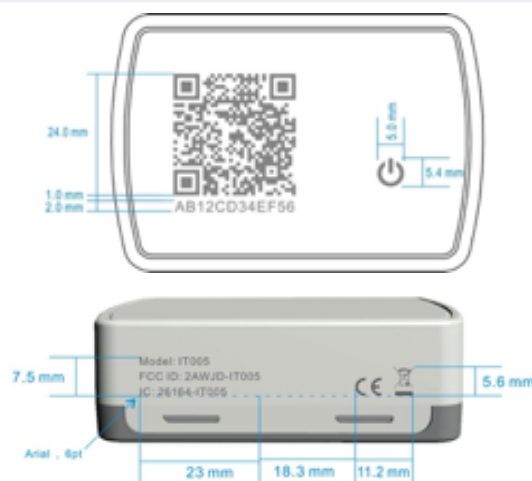

#### Part Number

ALE PN	OAL-AT-FIXED-8	Industrial Beacon OAL-AT-FIXED-8 with Accelerometer
Tatwah PN	BLE-IT005-017 BEA0541	Industrial Beacon IT005-017 with Accelerometer (BEA0541)